

# D-SUB Female Dual Row IDC Exterior Button Type (stamped Pin)

**ROHS COMPLIANT**

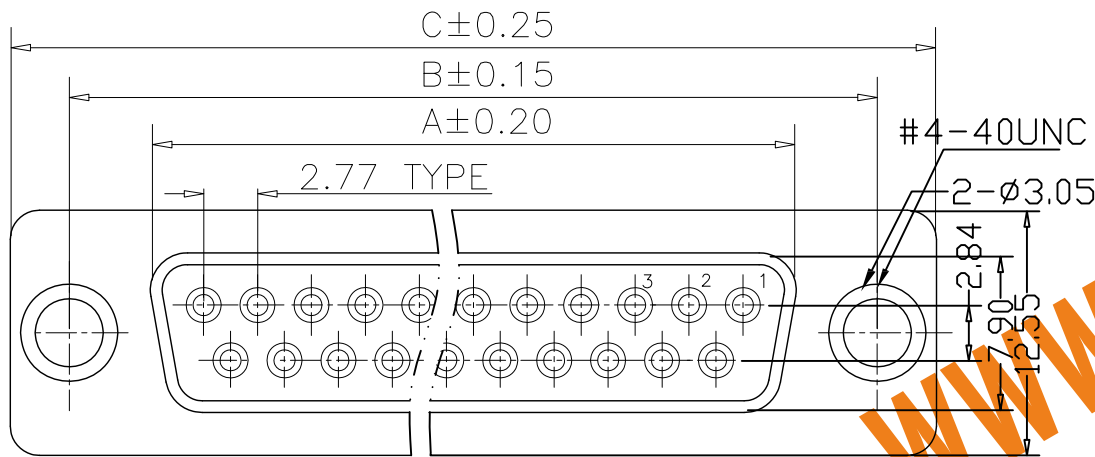

	09pin	15pin	25pin	37pin
A	16.33	24.66	38.38	54.84
B	24.99	33.32	47.04	63.50
C	30.80	39.10	53.00	69.30
D	11.86	19.50	32.15	48.76

**Material (材料):**  
 Housing (塑胶): Temperature Thermoplastics, PBT+G.F UL 94V-0  
 Contact (端子): Brass or Bronze  
 Shell (壳): 0.35T Steel Nickel Plating All Area

**Electical Characteristics (电气性能):**  
 Current Rating (额定电流): 5A  
 Contact Resistance (接触阻抗): 20 milliohms Max  
 Withstanding Voltage (耐电压): 500V AC For 1 Minute  
 Insulation Resistance (绝缘阻抗): 1000 Megohms Min  
 Operating Temperature (温度范围): -55° C to +105° C

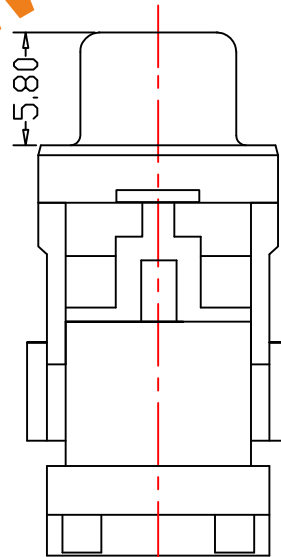
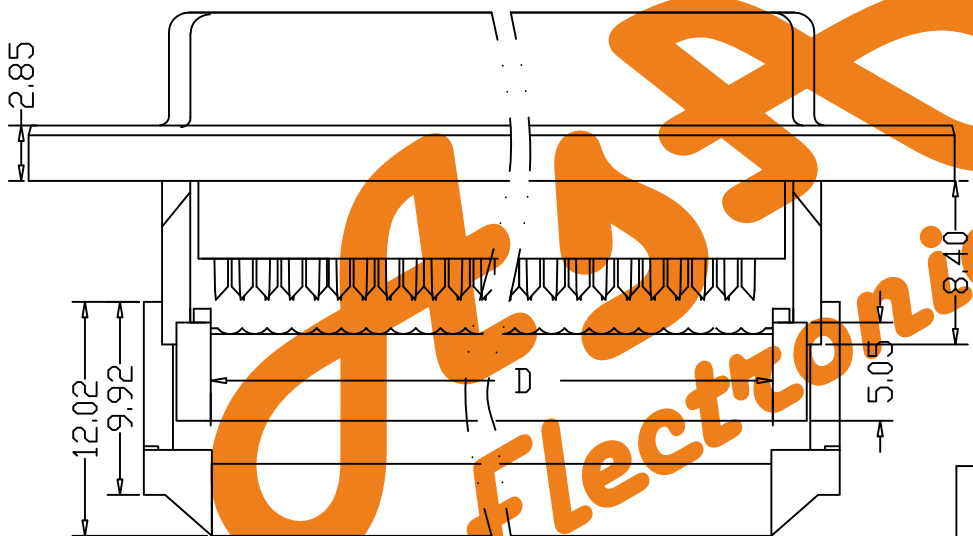

Ordering Code:

DIDC02 - F - X - S - X - X  
 ① ② ③ ④ ⑤ ⑥

- ① Dual Row IDC Type
- ② Contact Type:  
F:Female
- ③ Contact NO.:  
09=09pin  
15=15pin  
25=25pin  
37=37pin
- ④ Contact Plating  
S: Selective Gold  
G0: Gold flash  
G1: 3u" Gold  
G2: 5u" Gold  
G3: 10u" Gold  
G4: 15u" Gold  
G5: 30u" Gold
- ⑤ Color Code:  
L:Blue  
B:Black
- ⑥ Other Option:  
A: With S/R(Standard)  
B: Without S/R

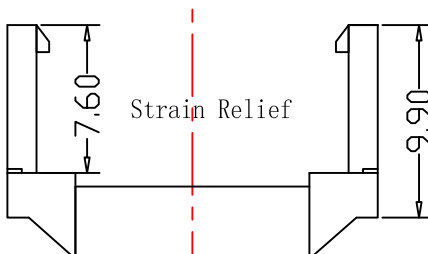

Unless Otherwise specified tolerance  
 X±0.35  
 X.X±0.25  
 X.XX±0.20  
 X.XXX±0.15

**AsA Electronic**  
 WWW.AsA-Elec.com

**AsA Electronic Co.**  
 Tel : (+98) 21 66 73 56 82 Mob : (+98) 912 03 161 02

SCALE: 1:1 UNIT: mm  
 DRAWN: junfon H  
 CHECKED: YANG

TITLE:  
D-SUB Female Dual Row IDC  
Exterior Button Type (stamped Pin)

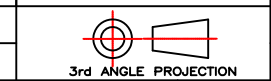

DRAWING NO: DIDC02-FXXXX  
 PRODUCT NO: DIDC02-FXXXX

11/3/1  
 DATE